

FLEX HOSE

Flex Hose Options

- Premium Triple S Stainless Steel (304 non magnetic) 4 PLY (**BEST**)

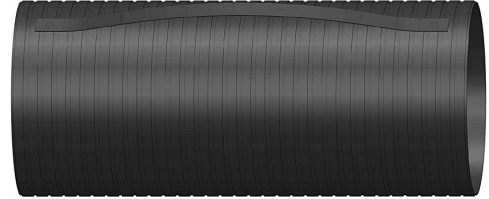

- 304 Stainless Conventional Flex (non magnetic) (**BETTER**)

- 409 Stainless Conventional Flex (magnetic) (**GOOD**)

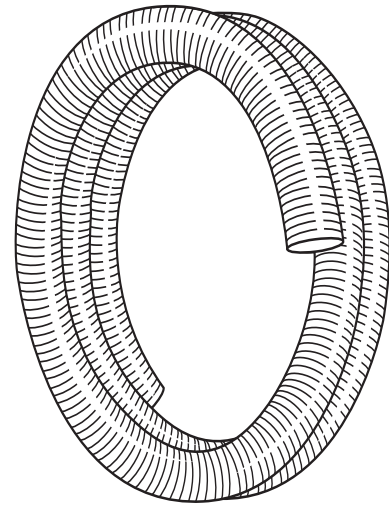

- Galvanized Conventional Flex
 - .018 Thick Strip (magnetic) (**GOOD**)

- Galvanized Conventional Flex
 - .015 Thick Strip (magnetic) (**GOOD**)

- Bellows, Single Ply
 - 304 Stainless (non magnetic) will not twist

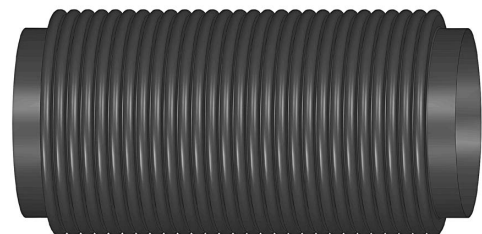

Stainless & Galvanized Boxed Flex Kits



Stainless Kits include .015 Premium-Grade 304 Stainless Flex Precut (single interlocked profile), & two WFC Pre-Formed 304 Stainless Premium -Grade clamps.

Galvanized Kits include .015 Galvanized Flex Precut, & two WFC Pre-Formed Aluminized Premium-Grade clamps.

TYPE 304 STAINLESS KITS:

PART NO.	DIA. / LENGTH
FK-412SS	4" X 12"
FK-418SS	4" X 18"
FK-424SS	4" X 24"
FK-436SS	4" X 36"
FK-512SS	5" X 12"
FK-518SS	5" X 18"
FK-524SS	5" X 24"
FK-536SS	5" X 36"

GALVANIZED KITS:

PART NO.	DIA. / LENGTH
FK-412G	4" X 12"
FK-418G	4" X 18"
FK-424G	4" X 24"
FK-436G	4" X 36"
FK-512G	5" X 12"
FK-518G	5" X 18"
FK-524G	5" X 24"
FK-536G	5" X 36"

FLEX HOSE

4" & 5" Stainless Flex User Guide

GOOD > BETTER > BEST

RATING = GOOD (Type 409 Stainless - Magnetic)

- Better corrosion resistance than Galvanized or Aluminized Flex
- Flexibility = STIFF, can be cut and trimmed

PART NO.	4" DIA/LENGTH
S49-4300	4" X 300" ROLL
S49-4120	4" X 120" ROLL
S49-418	4" X 18" PRECUT
S49-424	4" X 24" PRECUT
S49-436	4" X 36" PRECUT

PART NO.	5" DIA/LENGTH
S49-5300	5" X 300" ROLL
S49-5120	5" X 120" ROLL
S49-512	5" X 12" PRECUT
S49-518	5" X 18" PRECUT
S49-524	5" X 24" PRECUT
S49-536	5" X 36" PRECUT



RATING = BETTER (Type 304 Stainless - Non-Magnetic)

- Better quality stainless flex material — WILL NOT RUST OR CORRODE
- Flexibility on 10' & 25' Rolls = STIFF (typical), can be cut and trimmed
- Flexibility on 12" thru 48" Precuts = VERY FLEXIBLE, can be cut and trimmed

PART NO.	4" DIA/LENGTH
SF-4300	4" X 300" ROLL
SF-4120	4" X 120" ROLL
SF-412	4" X 12" PRECUT
SF-418	4" X 18" PRECUT
SF-424	4" X 24" PRECUT
SF-436	4" X 36" PRECUT
SF-448	4" X 48" PRECUT

PART NO.	5" DIA/LENGTH
SF-5300	5" X 300" ROLL
SF-5120	5" X 120" ROLL
SF-512	5" X 12" PRECUT
SF-518	5" X 18" PRECUT
SF-524	5" X 24" PRECUT
SF-536	5" X 36" PRECUT
SF-548	5" X 48" PRECUT



(Conventional Interlocked Profile)



RATING = BEST (OE Type SSS 304 Stainless - Non-Magnetic)

- Best quality stainless flex type — WILL NOT RUST OR CORRODE
- Precuts Only - Featuring EXTENSION GAUGE STRAP & Individually Boxed!
- SUPER FLEXIBLE & Torsional Movement, DO NOT cut or trim

PART NO.	4" DIA/LENGTH
WFF-412	4" X 12" PRECUT
WFF-415	4" X 15" PRECUT
WFF-418	4" X 18" PRECUT
WFF-424	4" X 24" PRECUT

PART NO.	5" DIA/LENGTH
WFF-512	5" X 12" PRECUT
WFF-515	5" X 15" PRECUT
WFF-518	5" X 18" PRECUT
WFF-521	5" X 21" PRECUT
WFF-524	5" X 24" PRECUT



TYPE SSS (33% THICKER)
• SPECIAL INTERLOCKED PROFILE •

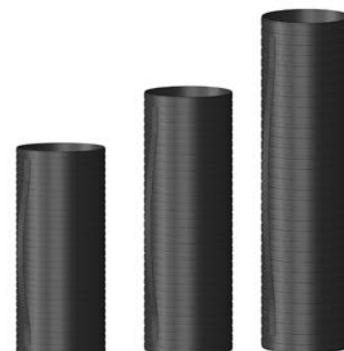

Flexible Metal Hose

PRECUT LENGTHS

DIA.	LENGTH	GALVANIZED	409 STAINLESS	HEAVY DUTY 304 STAINLESS
3"	24"	—	—	SF-324
3"	36"	—	—	SF-336
3.5"	12"	G15-3512	—	—
3.5"	18"	—	—	SF-3518
3.5"	24"	G15-3524	—	SF-3524
3.5"	36"	G15-3536	—	SF-3536
4"	12"	G15-412	S49-412	SF-412
4"	18"	G15-418	S49-418	SF-418
4"	24"	G15-424	S49-424	SF-424
4"	36"	G15-436	S49-436	SF-436
4"	48"	G15-448	—	SF-448
5"	12"	G15-512	S49-512	SF-512
5"	18"	G15-518	S49-518	SF-518
5"	24"	G15-524	S49-524	SF-524
5"	36"	G15-536	S49-536	SF-536
5"	48"	G15-548	—	SF-548

Various Pre-Cut Lengths:

- Save Money, Time and Hassle of Cutting
- Easier to Inventory and Handle
- Easier to Display
- Deburred Ends

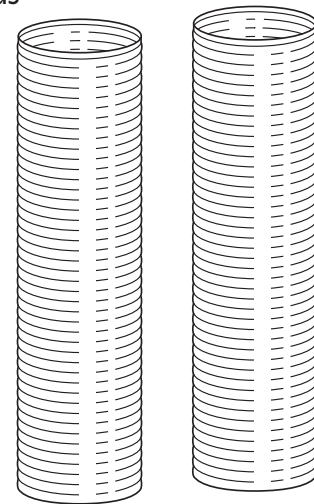

NOTE: All Grand Rock Flex is measured in RELAXED lengths.
• Compression may occur during handling and transit

120" and 300" COILS

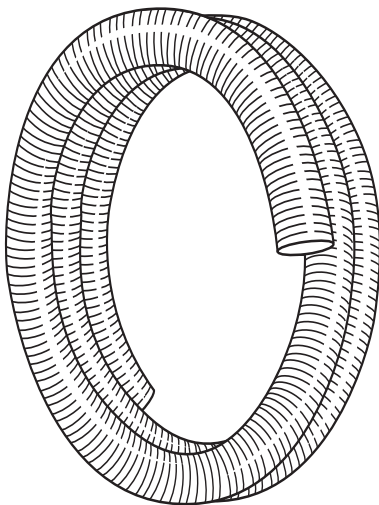

DIA.	STD. DUTY GALVANIZED 300" ROLL	STD. DUTY GALVANIZED 120" ROLL	HEAVY DUTY GALVANIZED 300" ROLL	HEAVY DUTY 304 STAINLESS 120" ROLL	HEAVY DUTY 304 STAINLESS 300" ROLL
1.5"	—	—	—	—	SF-15300
2"	G15-2300	—	—	—	—
2.5"	G15-25300	G15-25120	—	—	SF-25300
2.75"	G15-275300	—	—	—	SF-275300
3"	G15-3300	G15-3120	—	SF-3120	SF-3300
3.5"	G15-35300	G15-35120	—	SF-35120	SF-35300
4"	G15-4300	G15-4120	G18-4300	SF-4120	SF-4300
5"	G15-5300	G15-5120	G18-5300	SF-5120	SF-5300
6"	—	G15-6120	—	SF-6120	SF-6300
7"	—	—	—	SF-7120	—

FLEX HOSE

Westfalia Triple-S Flex Hose

BEST FLEX HOSE in THE MARKET

- 304 Stainless Steel Construction
- Moves easily in all directions
- Torsional Movement (twists)
- 4-ply construction is virtually leak-free & low emission
- Precut lengths to fit any flex application — eliminates cutting
- Individually boxed with installation instructions
- Longer life than other flex types
- Do not cut this product

PART NO.	DIA.	LENGTH
WFF-412	4"	12"
WFF-415	4"	15"
WFF-418	4"	18"
WFF-424	4"	24"
WFF-512	5"	12"
WFF-515	5"	15"
WFF-518	5"	18"
WFF-521	5"	21"
WFF-524	5"	24"

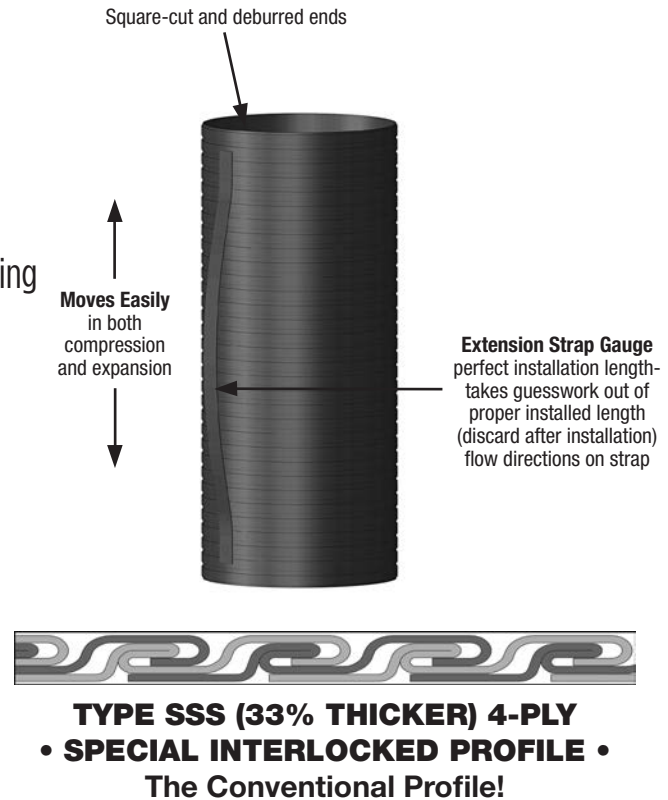

Universal Stainless Steel Bellows Pipe



- Single Ply 304 Stainless Steel

PART NO.	DIA.	LENGTH
GBS-312	3"	10"
GBS-3512	3.5"	10"
GBS-412	4"	10"
GBS-512	5"	10"